

FINAL-DEVELOPMENT DRAINAGE AREA PLAN

16 BRADY DRIVE

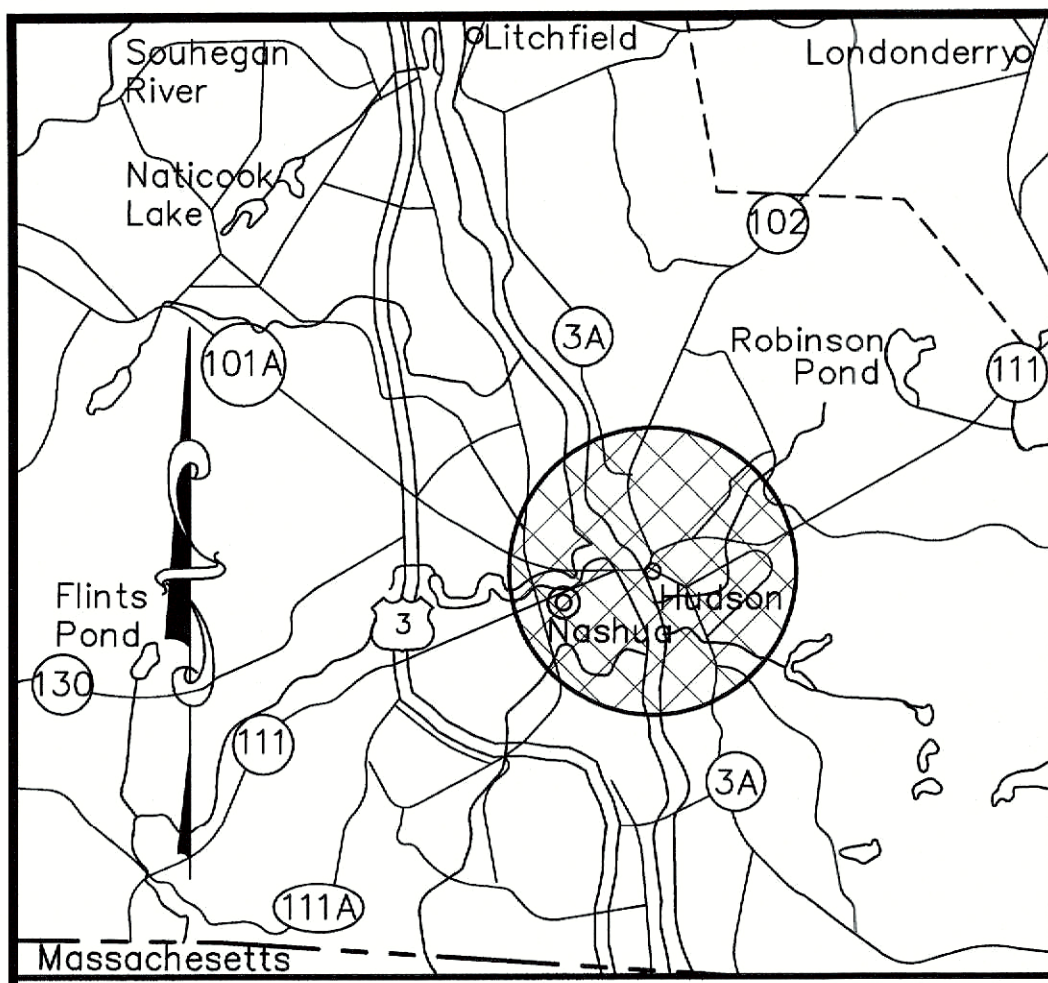

VICINITY PLAN
NOT TO SCALE

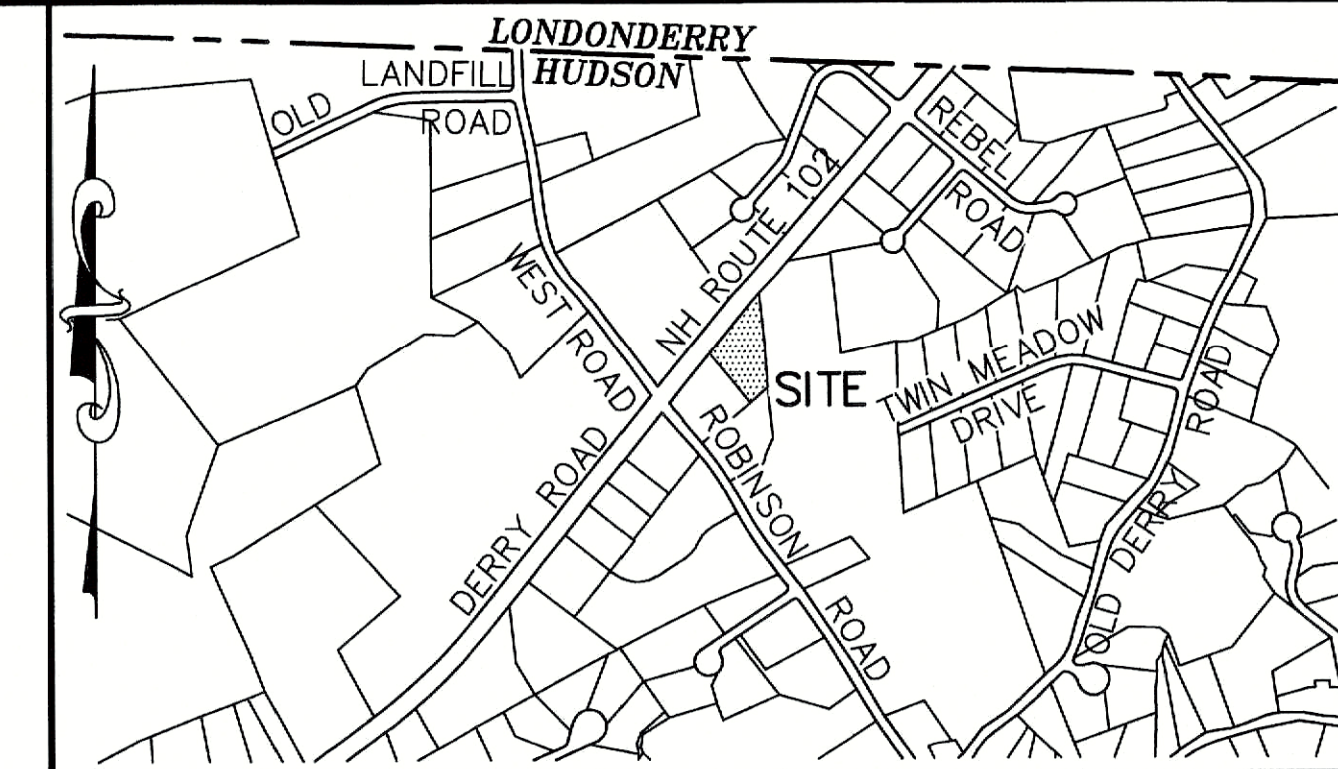

LOCATION PLAN
SCALE: 1" = 1,000'

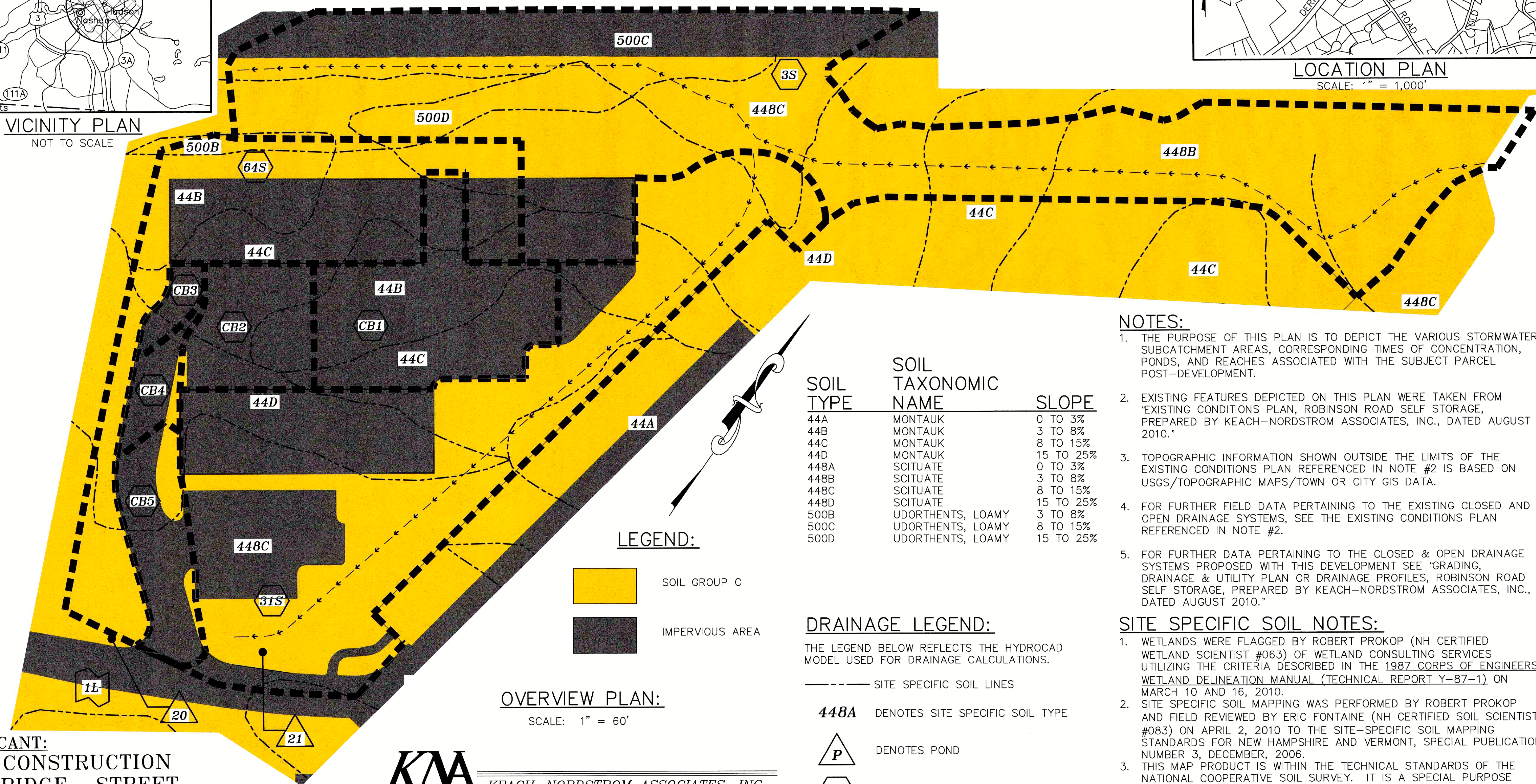

LEGEND:

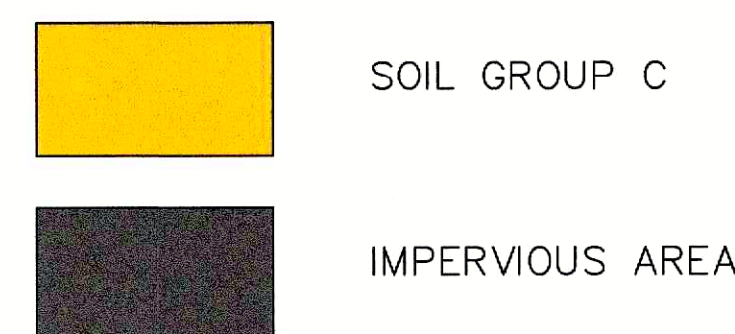

OVERVIEW PLAN:

SCALE: 1" = 60'

SOIL TYPE	SOIL TAXONOMIC NAME	SLOPE
44A	MONTAUK	0 TO 3%
44B	MONTAUK	3 TO 8%
44C	MONTAUK	8 TO 15%
44D	MONTAUK	15 TO 25%
448A	SCITUATE	0 TO 3%
448B	SCITUATE	3 TO 8%
448C	SCITUATE	8 TO 15%
448D	SCITUATE	15 TO 25%
500B	UDORTHENTS, LOAMY	3 TO 8%
500C	UDORTHENTS, LOAMY	8 TO 15%
500D	UDORTHENTS, LOAMY	15 TO 25%

DRAINAGE LEGEND:

THE LEGEND BELOW REFLECTS THE HYDROCAD MODEL USED FOR DRAINAGE CALCULATIONS.

- SITE SPECIFIC SOIL LINES
- 448A DENOTES SITE SPECIFIC SOIL TYPE
- P DENOTES POND
- S DENOTES SUBCATCHMENT AREA
- L DENOTES POINT OF INTEREST
- LIMIT OF SUBCATCHMENT AREA
- - - - TIME OF CONCENTRATION

NOTES:

- THE PURPOSE OF THIS PLAN IS TO DEPICT THE VARIOUS STORMWATER SUBCATCHMENT AREAS, CORRESPONDING TIMES OF CONCENTRATION, PONDS, AND REACHES ASSOCIATED WITH THE SUBJECT PARCEL POST-DEVELOPMENT.
- EXISTING FEATURES DEPICTED ON THIS PLAN WERE TAKEN FROM "EXISTING CONDITIONS PLAN, ROBINSON ROAD SELF STORAGE, PREPARED BY KEACH-NORDSTROM ASSOCIATES, INC., DATED AUGUST 2010."
- TOPOGRAPHIC INFORMATION SHOWN OUTSIDE THE LIMITS OF THE EXISTING CONDITIONS PLAN REFERENCED IN NOTE #2 IS BASED ON USGS/TOPOGRAPHIC MAPS/TOWN OR CITY GIS DATA.
- FOR FURTHER FIELD DATA PERTAINING TO THE EXISTING CLOSED AND OPEN DRAINAGE SYSTEMS, SEE THE EXISTING CONDITIONS PLAN REFERENCED IN NOTE #2.
- FOR FURTHER DATA PERTAINING TO THE CLOSED & OPEN DRAINAGE SYSTEMS PROPOSED WITH THIS DEVELOPMENT SEE "GRADING, DRAINAGE & UTILITY PLAN OR DRAINAGE PROFILES, ROBINSON ROAD SELF STORAGE, PREPARED BY KEACH-NORDSTROM ASSOCIATES, INC., DATED AUGUST 2010."

SITE SPECIFIC SOIL NOTES:

- WETLANDS WERE FLAGGED BY ROBERT PROKOP (NH CERTIFIED WETLAND SCIENTIST #063) OF WETLAND CONSULTING SERVICES UTILIZING THE CRITERIA DESCRIBED IN THE 1987 CORPS OF ENGINEERS WETLAND DELINEATION MANUAL (TECHNICAL REPORT Y-87-1) ON MARCH 10 AND 16, 2010.
- SITE SPECIFIC SOIL MAPPING WAS PERFORMED BY ROBERT PROKOP AND FIELD REVIEWED BY ERIC FONTAINE (NH CERTIFIED SOIL SCIENTIST #083) ON APRIL 2, 2010 TO THE SITE-SPECIFIC SOIL MAPPING STANDARDS FOR NEW HAMPSHIRE AND VERMONT, SPECIAL PUBLICATION NUMBER 3, DECEMBER, 2006.
- THIS MAP PRODUCT IS WITHIN THE TECHNICAL STANDARDS OF THE NATIONAL COOPERATIVE SOIL SURVEY. IT IS A SPECIAL PURPOSE PRODUCT, INTENDED FOR USE AS A PLANNING DOCUMENT FOR RESIDENTIAL SUBDIVISION CONSTRUCTION. IT WAS PRODUCED BY A CERTIFIED SOIL SCIENTIST, AND IS NOT A PRODUCT OF THE USDA NATURAL RESOURCES CONSERVATION SERVICE (NRCS). THERE IS A NARRATIVE REPORT DATED APRIL 6, 2010 THAT ACCOMPANIES THIS MAP.
- THE SOIL MAP UNITS IDENTIFIED FOR TAX MAP 105; LOTS 17, 18, 19 & 20, THAT TOTALS APPROXIMATELY 22.35 ACRES, AND IS LOCATED OFF ROBINSON ROAD IN HUDSON, NEW HAMPSHIRE ARE IDENTIFIED BELOW USING THE NEW HAMPSHIRE STATE-WIDE NUMERICAL SOILS LEGEND, ISSUE #5, JANUARY 1999:

APPLICANT:
KLN CONSTRUCTION
70 BRIDGE STREET
PELHAM, NH 03076

PREPARED BY:
MSE PROPERTIES LLC
20 SENTER FARM ROAD
HUDSON, NH 03051

KNA KEACH-NORDSTROM ASSOCIATES, INC.
Civil Engineering Land Surveying Landscape Architecture

10 Commerce Park North, Suite 3B
Bedford, NH 03110
Phone (603) 627-2881

AUGUST 5, 2025
PROJECT NO. 24-1220-1

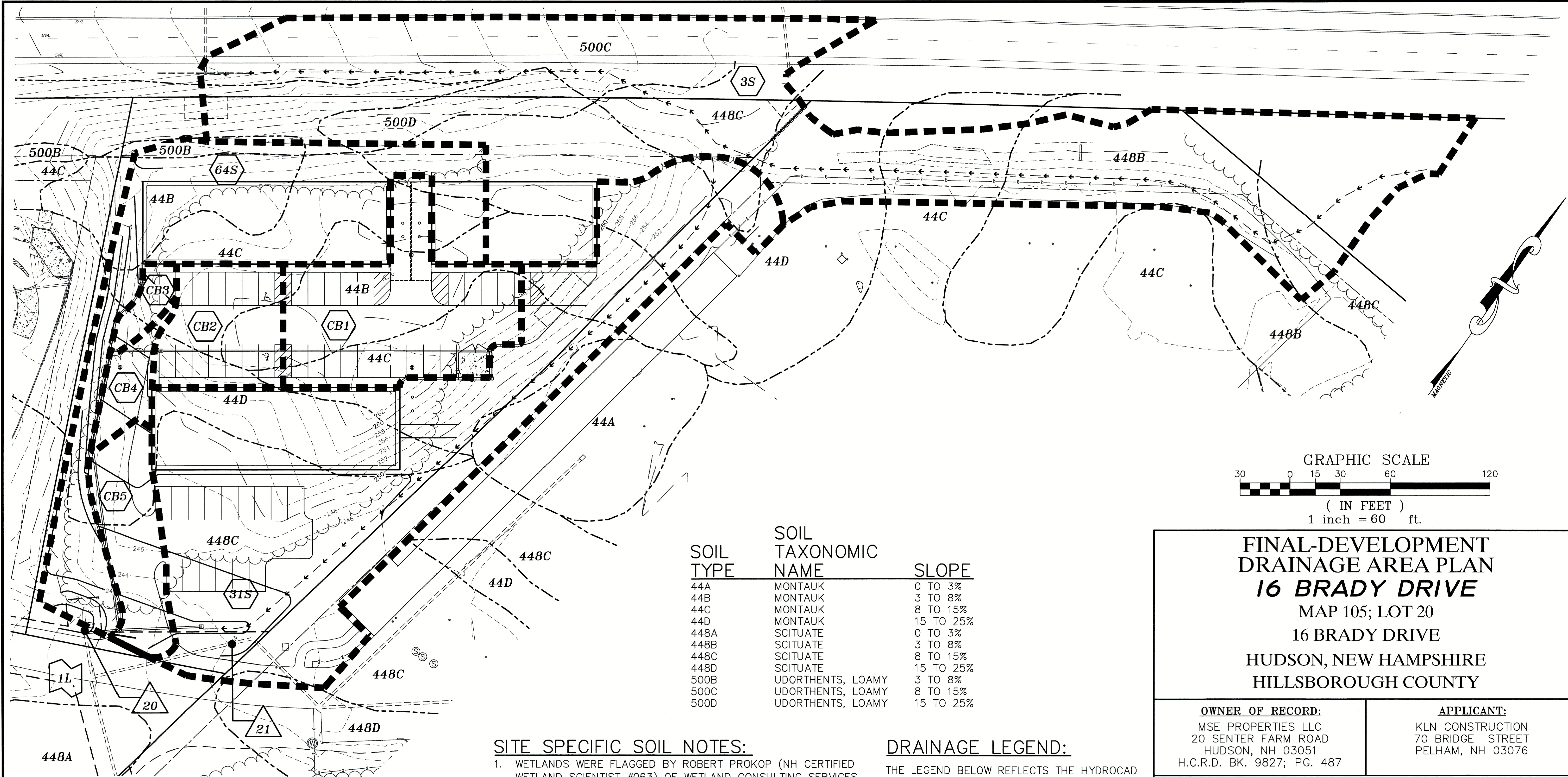

- NOTES:**
1. THE PURPOSE OF THIS PLAN IS TO DEPICT THE VARIOUS STORMWATER SUBCATCHMENT AREAS, CORRESPONDING TIMES OF CONCENTRATION, PONDS, AND REACHES ASSOCIATED WITH THE SUBJECT PARCEL POST-DEVELOPMENT.
 2. EXISTING FEATURES DEPICTED ON THIS PLAN WERE TAKEN FROM "EXISTING CONDITIONS PLAN, ROBINSON ROAD SELF STORAGE, PREPARED BY KEACH-NORDSTROM ASSOCIATES, INC., DATED AUGUST 2010."
 3. TOPOGRAPHIC INFORMATION SHOWN OUTSIDE THE LIMITS OF THE EXISTING CONDITIONS PLAN REFERENCED IN NOTE #2 IS BASED ON USGS/TOPOGRAPHIC MAPS/TOWN OR CITY GIS DATA.
 4. FOR FURTHER FIELD DATA PERTAINING TO THE EXISTING CLOSED AND OPEN DRAINAGE SYSTEMS, SEE THE EXISTING CONDITIONS PLAN REFERENCED IN NOTE #2.
 5. FOR FURTHER DATA PERTAINING TO THE CLOSED & OPEN DRAINAGE SYSTEMS PROPOSED WITH THIS DEVELOPMENT SEE "GRADING, DRAINAGE & UTILITY PLAN OR DRAINAGE PROFILES, ROBINSON ROAD SELF STORAGE, PREPARED BY KEACH-NORDSTROM ASSOCIATES, INC., DATED AUGUST 2010."

- SITE SPECIFIC SOIL NOTES:**
1. WETLANDS WERE FLAGGED BY ROBERT PROKOP (NH CERTIFIED WETLAND SCIENTIST #063) OF WETLAND CONSULTING SERVICES UTILIZING THE CRITERIA DESCRIBED IN THE 1987 CORPS OF ENGINEERS WETLAND DELINEATION MANUAL (TECHNICAL REPORT Y-87-1) ON MARCH 10 AND 16, 2010.
 2. SITE SPECIFIC SOIL MAPPING WAS PERFORMED BY ROBERT PROKOP AND FIELD REVIEWED BY ERIC FONTAINE (NH CERTIFIED SOIL SCIENTIST #083) ON APRIL 2, 2010 TO THE SITE-SPECIFIC SOIL MAPPING STANDARDS FOR NEW HAMPSHIRE AND VERMONT, SPECIAL PUBLICATION NUMBER 3, DECEMBER, 2006.
 3. THIS MAP PRODUCT IS WITHIN THE TECHNICAL STANDARDS OF THE NATIONAL COOPERATIVE SOIL SURVEY. IT IS A SPECIAL PURPOSE PRODUCT, INTENDED FOR USE AS A PLANNING DOCUMENT FOR RESIDENTIAL SUBDIVISION CONSTRUCTION. IT WAS PRODUCED BY A CERTIFIED SOIL SCIENTIST, AND IS NOT A PRODUCT OF THE USDA NATURAL RESOURCES CONSERVATION SERVICE (NRCS). THERE IS A NARRATIVE REPORT DATED APRIL 6, 2010 THAT ACCOMPANIES THIS MAP.
 4. THE SOIL MAP UNITS IDENTIFIED FOR TAX MAP 105; LOTS 17, 18, 19 & 20, THAT TOTALS APPROXIMATELY 22.35 ACRES, AND IS LOCATED OFF ROBINSON ROAD IN HUDSON, NEW HAMPSHIRE ARE IDENTIFIED BELOW USING THE NEW HAMPSHIRE STATE-WIDE NUMERICAL SOILS LEGEND, ISSUE #5, JANUARY 1999:

SOIL TYPE	SOIL TAXONOMIC NAME	SLOPE
44A	MONTAUK	0 TO 3%
44B	MONTAUK	3 TO 8%
44C	MONTAUK	8 TO 15%
44D	MONTAUK	15 TO 25%
448A	SCITUATE	0 TO 3%
448B	SCITUATE	3 TO 8%
448C	SCITUATE	8 TO 15%
448D	SCITUATE	15 TO 25%
500B	UDORTHENTS, LOAMY	3 TO 8%
500C	UDORTHENTS, LOAMY	8 TO 15%
500D	UDORTHENTS, LOAMY	15 TO 25%

- DRAINAGE LEGEND:**
- THE LEGEND BELOW REFLECTS THE HYDROCAD MODEL USED FOR DRAINAGE CALCULATIONS.
- SITE SPECIFIC SOIL LINES
 - 448A** DENOTES SITE SPECIFIC SOIL TYPE
 - P** DENOTES POND
 - S** DENOTES SUBCATCHMENT AREA
 - L** DENOTES POINT OF INTEREST
 - LIMIT OF SUBCATCHMENT AREA
 - TIME OF CONCENTRATION

FINAL-DEVELOPMENT DRAINAGE AREA PLAN
16 BRADY DRIVE
MAP 105; LOT 20
16 BRADY DRIVE
HUDSON, NEW HAMPSHIRE
HILLSBOROUGH COUNTY

OWNER OF RECORD:
MSE PROPERTIES LLC
20 SENTER FARM ROAD
HUDSON, NH 03051
H.C.R.D. BK. 9827; PG. 487

APPLICANT:
KLN CONSTRUCTION
70 BRIDGE STREET
PELHAM, NH 03076

KEACH-NORDSTROM ASSOCIATES, INC.
Civil Engineering Land Surveying Landscape Architecture
10 Commerce Park North, Suite 3B
Bedford, NH 03110
Phone (603) 627-2881

REVISIONS			
No.	DATE	DESCRIPTION	BY

DATE: AUGUST 5, 2025
PROJECT NO: 24-1220-1

SCALE: 1" = 60'
SHEET 1 OF 1

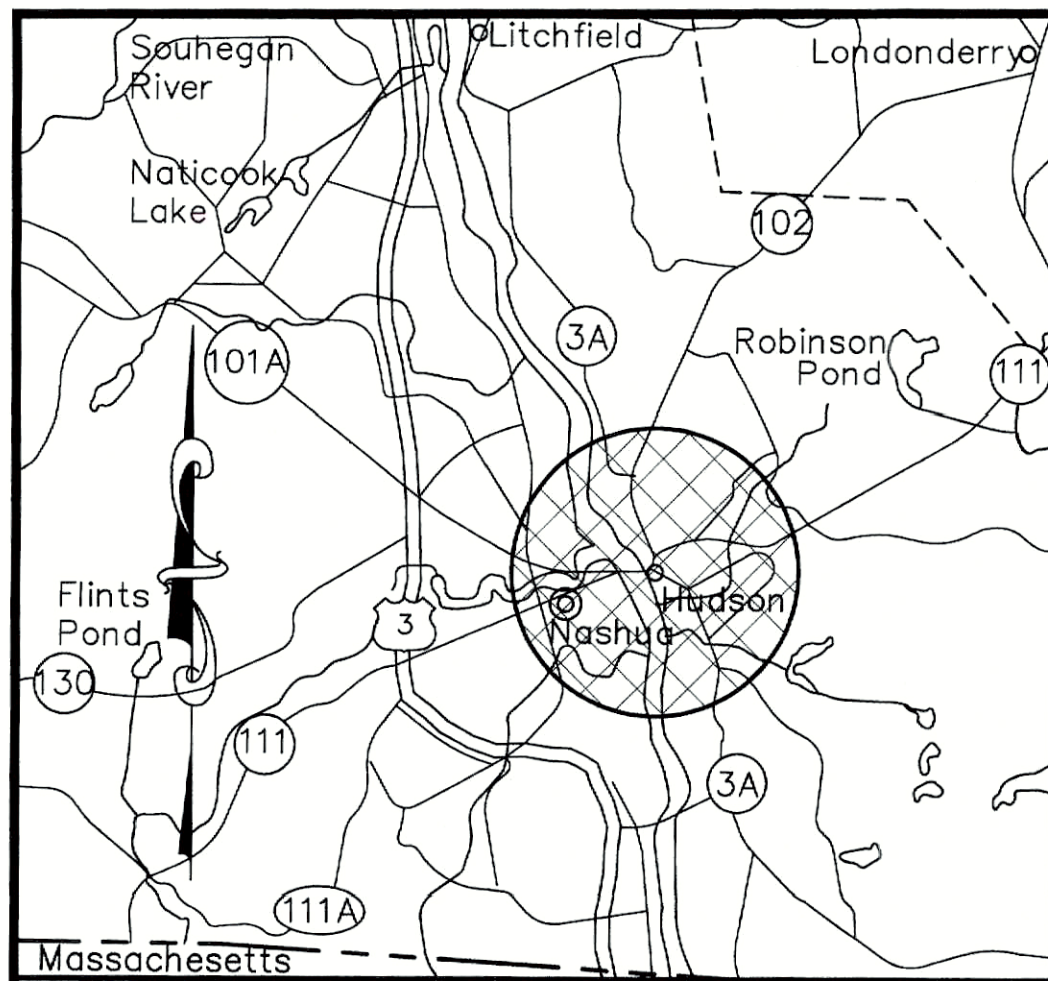

VICINITY PLAN
NOT TO SCALE

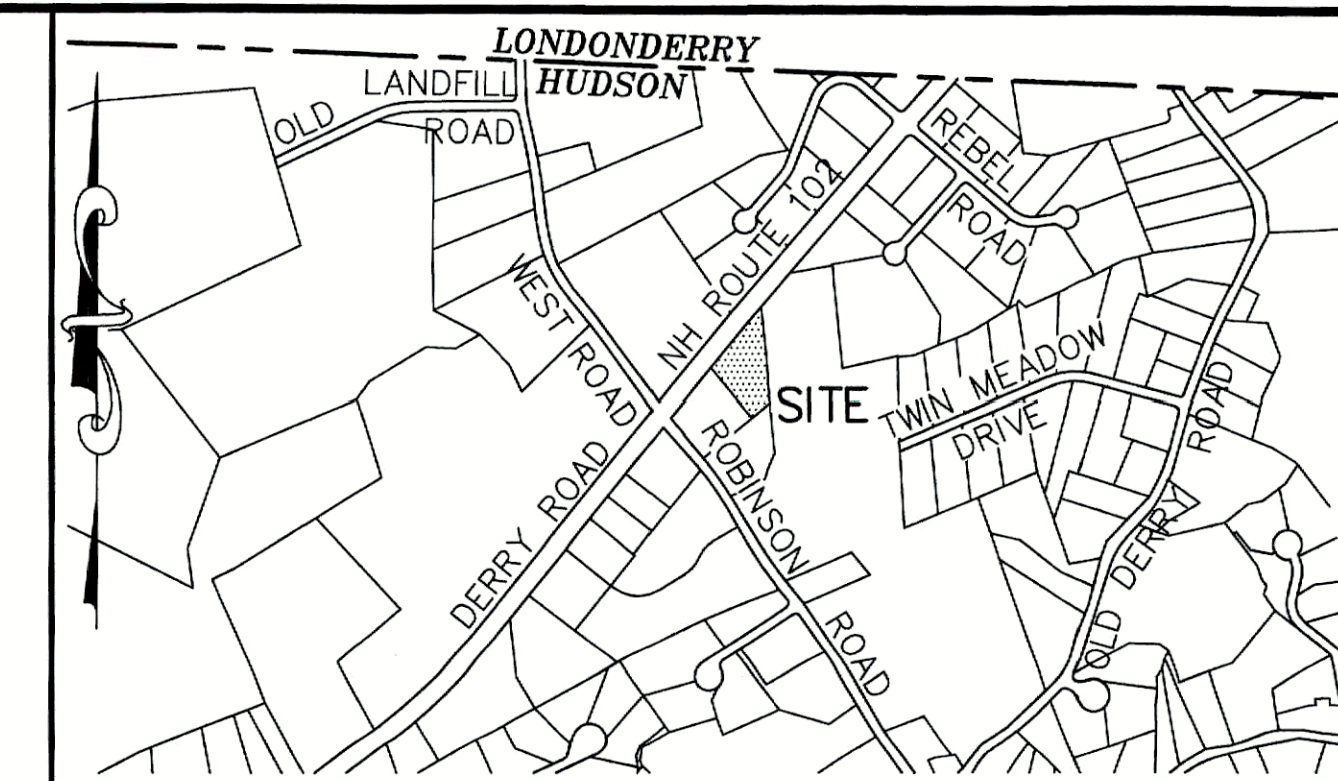

LOCATION PLAN
SCALE: 1" = 1,000'

POST-DEVELOPMENT DRAINAGE AREA PLAN 16 BRADY DRIVE

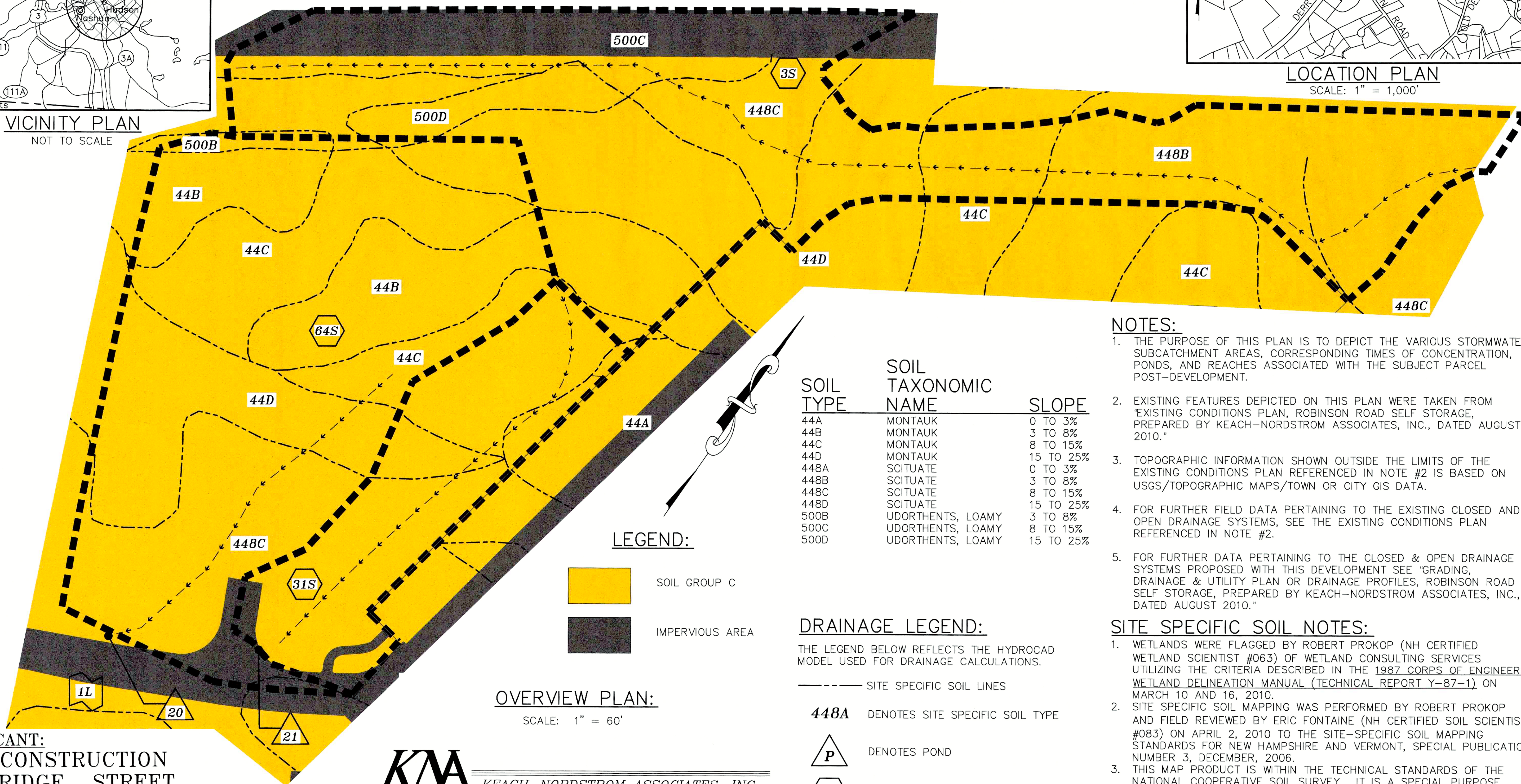

LEGEND:

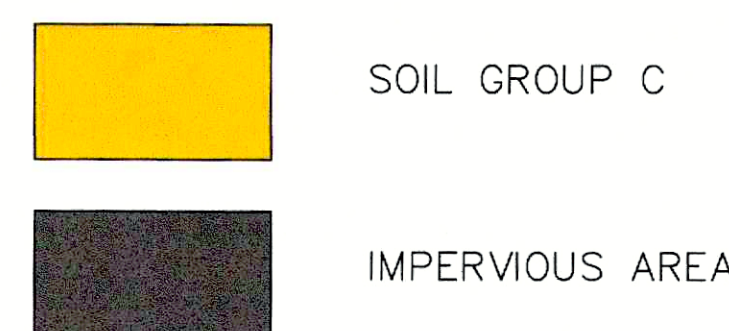

OVERVIEW PLAN:

SCALE: 1" = 60'

SOIL TYPE	SOIL TAXONOMIC NAME	SLOPE
44A	MONTAUK	0 TO 3%
44B	MONTAUK	3 TO 8%
44C	MONTAUK	8 TO 15%
44D	MONTAUK	15 TO 25%
448A	SCITUATE	0 TO 3%
448B	SCITUATE	3 TO 8%
448C	SCITUATE	8 TO 15%
448D	SCITUATE	15 TO 25%
500B	UDORTHENTS, LOAMY	3 TO 8%
500C	UDORTHENTS, LOAMY	8 TO 15%
500D	UDORTHENTS, LOAMY	15 TO 25%

DRAINAGE LEGEND:

THE LEGEND BELOW REFLECTS THE HYDROCAD MODEL USED FOR DRAINAGE CALCULATIONS.

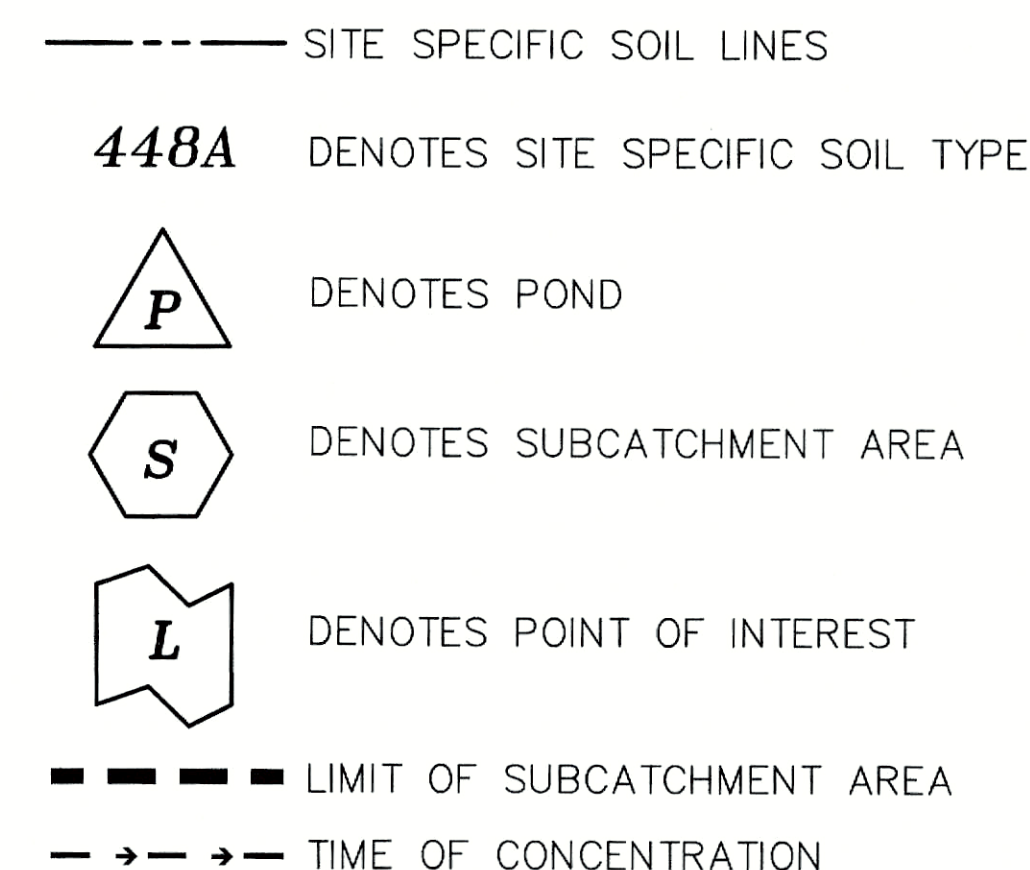

NOTES:

1. THE PURPOSE OF THIS PLAN IS TO DEPICT THE VARIOUS STORMWATER SUBCATCHMENT AREAS, CORRESPONDING TIMES OF CONCENTRATION, PONDS, AND REACHES ASSOCIATED WITH THE SUBJECT PARCEL POST-DEVELOPMENT.
2. EXISTING FEATURES DEPICTED ON THIS PLAN WERE TAKEN FROM "EXISTING CONDITIONS PLAN, ROBINSON ROAD SELF STORAGE, PREPARED BY KEACH-NORDSTROM ASSOCIATES, INC., DATED AUGUST 2010."
3. TOPOGRAPHIC INFORMATION SHOWN OUTSIDE THE LIMITS OF THE EXISTING CONDITIONS PLAN REFERENCED IN NOTE #2 IS BASED ON USGS/TOPOGRAPHIC MAPS/TOWN OR CITY GIS DATA.
4. FOR FURTHER FIELD DATA PERTAINING TO THE EXISTING CLOSED AND OPEN DRAINAGE SYSTEMS, SEE THE EXISTING CONDITIONS PLAN REFERENCED IN NOTE #2.
5. FOR FURTHER DATA PERTAINING TO THE CLOSED & OPEN DRAINAGE SYSTEMS PROPOSED WITH THIS DEVELOPMENT SEE "GRADING, DRAINAGE & UTILITY PLAN OR DRAINAGE PROFILES, ROBINSON ROAD SELF STORAGE, PREPARED BY KEACH-NORDSTROM ASSOCIATES, INC., DATED AUGUST 2010."

SITE SPECIFIC SOIL NOTES:

1. WETLANDS WERE FLAGGED BY ROBERT PROKOP (NH CERTIFIED WETLAND SCIENTIST #063) OF WETLAND CONSULTING SERVICES UTILIZING THE CRITERIA DESCRIBED IN THE 1987 CORPS OF ENGINEERS WETLAND DELINEATION MANUAL (TECHNICAL REPORT Y-87-1) ON MARCH 10 AND 16, 2010.
2. SITE SPECIFIC SOIL MAPPING WAS PERFORMED BY ROBERT PROKOP AND FIELD REVIEWED BY ERIC FONTAINE (NH CERTIFIED SOIL SCIENTIST #083) ON APRIL 2, 2010 TO THE SITE-SPECIFIC SOIL MAPPING STANDARDS FOR NEW HAMPSHIRE AND VERMONT, SPECIAL PUBLICATION NUMBER 3, DECEMBER, 2006.
3. THIS MAP PRODUCT IS WITHIN THE TECHNICAL STANDARDS OF THE NATIONAL COOPERATIVE SOIL SURVEY. IT IS A SPECIAL PURPOSE PRODUCT, INTENDED FOR USE AS A PLANNING DOCUMENT FOR RESIDENTIAL SUBDIVISION CONSTRUCTION. IT WAS PRODUCED BY A CERTIFIED SOIL SCIENTIST, AND IS NOT A PRODUCT OF THE USDA NATURAL RESOURCES CONSERVATION SERVICE (NRCS). THERE IS A NARRATIVE REPORT DATED APRIL 6, 2010 THAT ACCOMPANIES THIS MAP.
4. THE SOIL MAP UNITS IDENTIFIED FOR TAX MAP 105; LOTS 17, 18, 19 & 20, THAT TOTALS APPROXIMATELY 22.35 ACRES, AND IS LOCATED OFF ROBINSON ROAD IN HUDSON, NEW HAMPSHIRE ARE IDENTIFIED BELOW USING THE NEW HAMPSHIRE STATE-WIDE NUMERICAL SOILS LEGEND, ISSUE #5, JANUARY 1999:

APPLICANT:
KLN CONSTRUCTION
70 BRIDGE STREET
PELHAM, NH 03076

PREPARED BY:
MSE PROPERTIES LLC
20 SENTER FARM ROAD
HUDSON, NH 03051

KMA KEACH-NORDSTROM ASSOCIATES, INC.
Civil Engineering Land Surveying Landscape Architecture

10 Commerce Park North, Suite 3B
Bedford, NH 03110
Phone (603) 627-2881

AUGUST 5, 2025
PROJECT NO. 24-1220-1

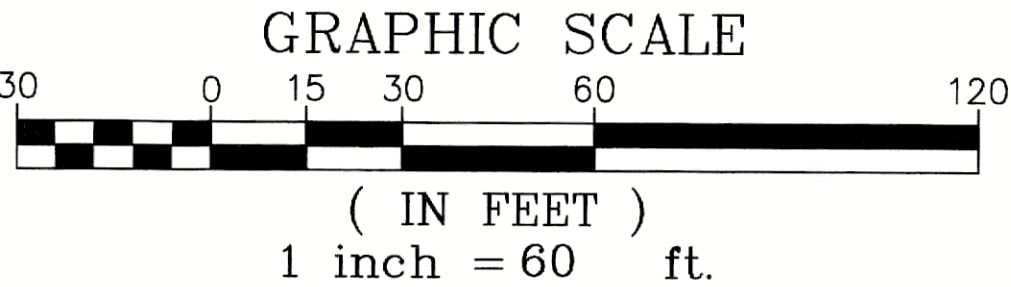
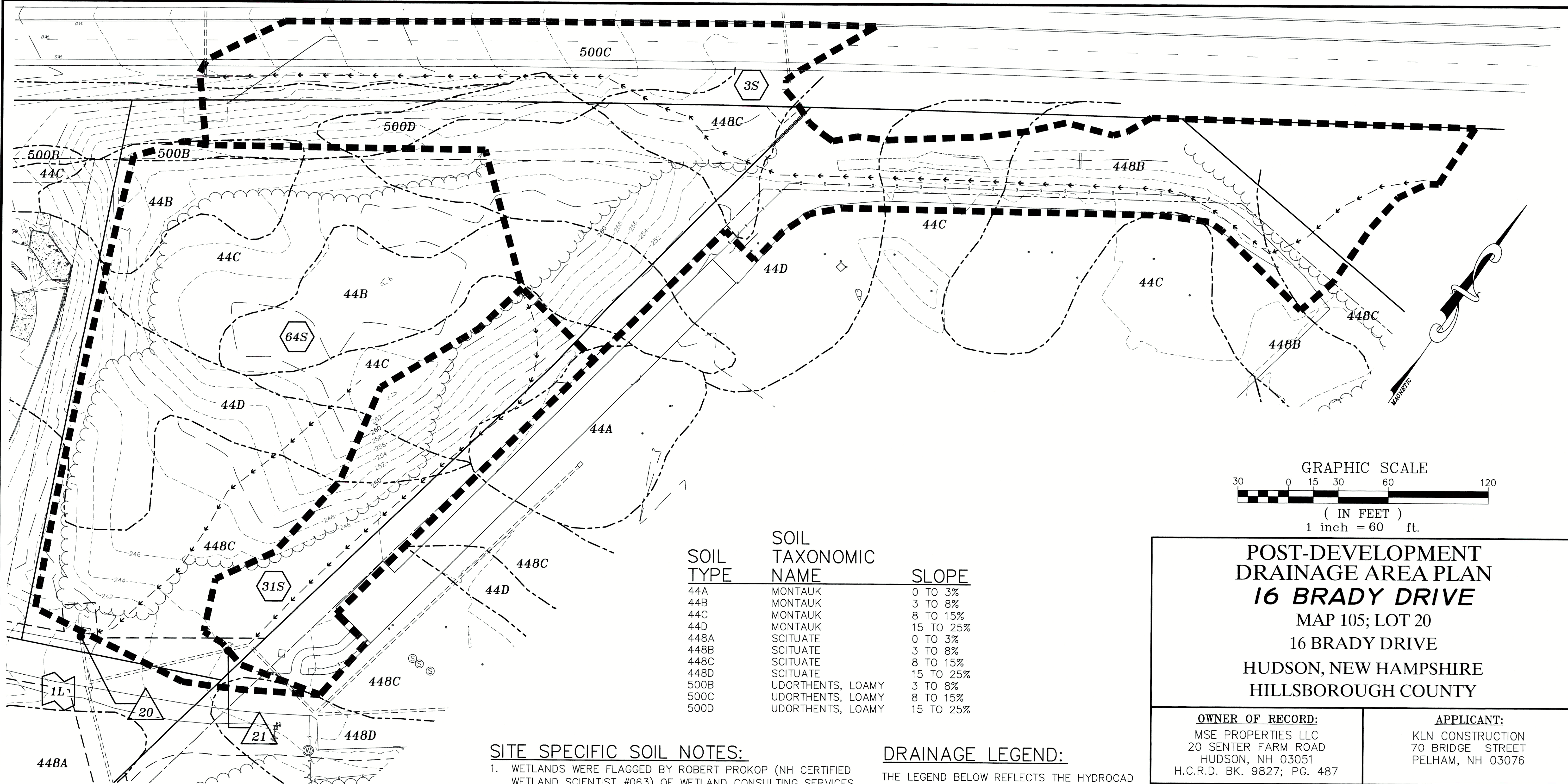

SOIL TYPE	SOIL TAXONOMIC NAME	SLOPE
44A	MONTAUK	0 TO 3%
44B	MONTAUK	3 TO 8%
44C	MONTAUK	8 TO 15%
44D	MONTAUK	15 TO 25%
448A	SCITUATE	0 TO 3%
448B	SCITUATE	3 TO 8%
448C	SCITUATE	8 TO 15%
448D	SCITUATE	15 TO 25%
500B	UDORTHENTS, LOAMY	3 TO 8%
500C	UDORTHENTS, LOAMY	8 TO 15%
500D	UDORTHENTS, LOAMY	15 TO 25%

SITE SPECIFIC SOIL NOTES:

- WETLANDS WERE FLAGGED BY ROBERT PROKOP (NH CERTIFIED WETLAND SCIENTIST #063) OF WETLAND CONSULTING SERVICES UTILIZING THE CRITERIA DESCRIBED IN THE 1987 CORPS OF ENGINEERS WETLAND DELINEATION MANUAL (TECHNICAL REPORT Y-87-1) ON MARCH 10 AND 16, 2010.
- SITE SPECIFIC SOIL MAPPING WAS PERFORMED BY ROBERT PROKOP AND FIELD REVIEWED BY ERIC FONTAINE (NH CERTIFIED SOIL SCIENTIST #083) ON APRIL 2, 2010 TO THE SITE-SPECIFIC SOIL MAPPING STANDARDS FOR NEW HAMPSHIRE AND VERMONT, SPECIAL PUBLICATION NUMBER 3, DECEMBER, 2006.
- THIS MAP PRODUCT IS WITHIN THE TECHNICAL STANDARDS OF THE NATIONAL COOPERATIVE SOIL SURVEY. IT IS A SPECIAL PURPOSE PRODUCT, INTENDED FOR USE AS A PLANNING DOCUMENT FOR RESIDENTIAL SUBDIVISION CONSTRUCTION. IT WAS PRODUCED BY A CERTIFIED SOIL SCIENTIST, AND IS NOT A PRODUCT OF THE USDA NATURAL RESOURCES CONSERVATION SERVICE (NRCS). THERE IS A NARRATIVE REPORT DATED APRIL 6, 2010 THAT ACCOMPANIES THIS MAP.
- THE SOIL MAP UNITS IDENTIFIED FOR TAX MAP 105; LOTS 17, 18, 19 & 20, THAT TOTALS APPROXIMATELY 22.35 ACRES, AND IS LOCATED OFF ROBINSON ROAD IN HUDSON, NEW HAMPSHIRE ARE IDENTIFIED BELOW USING THE NEW HAMPSHIRE STATE-WIDE NUMERICAL SOILS LEGEND, ISSUE #5, JANUARY 1999:

DRAINAGE LEGEND:

THE LEGEND BELOW REFLECTS THE HYDROCAD MODEL USED FOR DRAINAGE CALCULATIONS.

- SITE SPECIFIC SOIL LINES
- 448A DENOTES SITE SPECIFIC SOIL TYPE
- P DENOTES POND
- S DENOTES SUBCATCHMENT AREA
- L DENOTES POINT OF INTEREST
- LIMIT OF SUBCATCHMENT AREA
- - - - TIME OF CONCENTRATION

NOTES:

- THE PURPOSE OF THIS PLAN IS TO DEPICT THE VARIOUS STORMWATER SUBCATCHMENT AREAS, CORRESPONDING TIMES OF CONCENTRATION, PONDS, AND REACHES ASSOCIATED WITH THE SUBJECT PARCEL POST-DEVELOPMENT.
- EXISTING FEATURES DEPICTED ON THIS PLAN WERE TAKEN FROM "EXISTING CONDITIONS PLAN, ROBINSON ROAD SELF STORAGE, PREPARED BY KEACH-NORDSTROM ASSOCIATES, INC., DATED AUGUST 2010."
- TOPOGRAPHIC INFORMATION SHOWN OUTSIDE THE LIMITS OF THE EXISTING CONDITIONS PLAN REFERENCED IN NOTE #2 IS BASED ON USGS/TOPOGRAPHIC MAPS/TOWN OR CITY GIS DATA.
- FOR FURTHER FIELD DATA PERTAINING TO THE EXISTING CLOSED AND OPEN DRAINAGE SYSTEMS, SEE THE EXISTING CONDITIONS PLAN REFERENCED IN NOTE #2.
- FOR FURTHER DATA PERTAINING TO THE CLOSED & OPEN DRAINAGE SYSTEMS PROPOSED WITH THIS DEVELOPMENT SEE "GRADING, DRAINAGE & UTILITY PLAN OR DRAINAGE PROFILES, ROBINSON ROAD SELF STORAGE, PREPARED BY KEACH-NORDSTROM ASSOCIATES, INC., DATED AUGUST 2010."

POST-DEVELOPMENT
DRAINAGE AREA PLAN
16 BRADY DRIVE
MAP 105; LOT 20
16 BRADY DRIVE
HUDSON, NEW HAMPSHIRE
HILLSBOROUGH COUNTY

OWNER OF RECORD:
MSE PROPERTIES LLC
20 SENTER FARM ROAD
HUDSON, NH 03051
H.C.R.D. BK. 9827; PG. 487

APPLICANT:
KLN CONSTRUCTION
70 BRIDGE STREET
PELHAM, NH 03076

KMA KEACH-NORDSTROM ASSOCIATES, INC.
Civil Engineering Land Surveying Landscape Architecture
10 Commerce Park North, Suite 3B
Bedford, NH 03110
Phone (603) 627-2881

REVISIONS			
No.	DATE	DESCRIPTION	BY
DATE: AUGUST 5, 2025		SCALE: 1" = 60'	
PROJECT NO: 24-1220-1		SHEET 1 OF 1	